

- Compact body ported units
- Port sizes G1/8 and G1/4
- Unique deflector plate ensuring maximum water and particulate removal
- Solid control piston with lip seal for extended life.
- Proportional oil delivery over a wide range of air flows.



Operating information

Working pressure:	Max 10 bar
Working temperature:	0 °C to +52 °C

Flow characteristics

Flow	Filter	11 l/s
	Regulator	9,3 l/s
	Filter Regulator	9,3 l/s
	Lubricator	10 l/s

For more information see www.parker.com/euro_pneumatic

Filters - 5 micron element, transparent bowl

Port size	Description	Order Code
G1/8	Manual drain	14F01BB1
G1/8	Auto drain	14F05BB1
G1/4	Manual drain	14F11BB1
G1/4	Auto drain	14F15BB1
	Mounting bracket	PS417BP

Regulators - relieving type - non relieving options available

Port size	Description	Order Code
G1/8	2 bar	14R010FC1
G1/8	4 bar	14R011FC1
G1/8	8 bar	14R013FC1
G1/4	2 bar	14R110FC1
G1/4	4 bar	14R111FC1
G1/4	8 bar	14R113FC1
	Mounting bracket (Includes panel mounting nut)	PS417BP

Lubricators - transparent bowl

Port size	Order Code
G1/8	04L00GB1
G1/4	04L10GB1
	Mounting bracket PS419

Pressure Gauges

	Order Code
0 - 2 bar	P3D-KAB1AYN
0 - 4 bar	P3D-KAB1ALN
0 - 8 bar	P3D-KAB1ANN

Coalescing Filters - 0.01 micron element

Port size	Description	Order Code
Poly bowl		
G1/8	Manual drain	10F01ED1
G1/8	Auto drain	10F05ED1
G1/4	Manual drain	10F11ED1
G1/4	Auto drain	10F15ED1
	Mounting bracket	PS417BP

Filter/Regulators

- transparent bowl - 2 and 4 bar and non relieving options available

Port size	Description	Order Code
G1/8	2 bar, manual drain	14E01B10FC1
G1/8	2 bar, auto drain	14E05B10FC1
G1/4	2 bar, manual drain	14E11B10FC1
G1/4	2 bar, auto drain	14E15B10FC1
G1/8	4 bar, manual drain	14E01B11FC1
G1/8	4 bar, auto drain	14E05B11FC1
G1/4	4 bar, manual drain	14E11B11FC1
G1/4	4 bar, auto drain	14E15B11FC1
G1/8	8 bar, manual drain	14E01B13FC1
G1/8	8 bar, auto drain	14E05B13FC1
G1/4	8 bar, manual drain	14E11B13FC1
G1/4	8 bar, auto drain	14E15B13FC1
	Mounting bracket (Includes panel mounting nut)	PS417BP

Dimensions (mm)

Filters

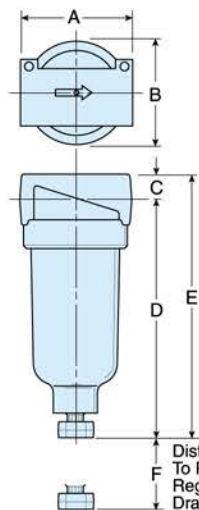

Distance Required To Remove All Bowls Regardless Of Drain Option

Coalescing Filters

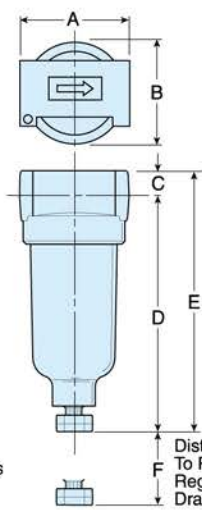

Distance Required To Remove All Bowls Regardless Of Drain Option

A	B	C	D	D'	E	E'	F
43	39	10	97	99	107	108	41

A	B	C	D	D'	E	E'	F
43	39,6	10	97	93	107	103	41

Filter/Regulators

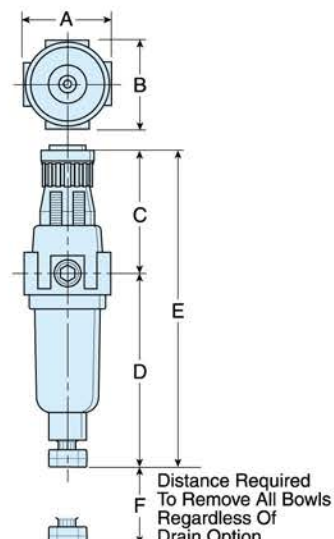

Distance Required To Remove All Bowls Regardless Of Drain Option

A	B	C	D	D'	E	E'	F
41	40	61	96	92	158	154	41

Regulators

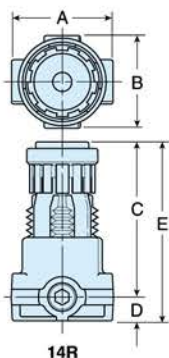

14R

14R	A	B	C	D	E
	42	40	63,5	10	731

14R**L*	A	B	C	D	E
	42	40	57,9	10	68

14RM	A	B	C	D	E	F	G	H	J
	38	38	60	13	73	30	15	8	18

Mounting Bracket Kits

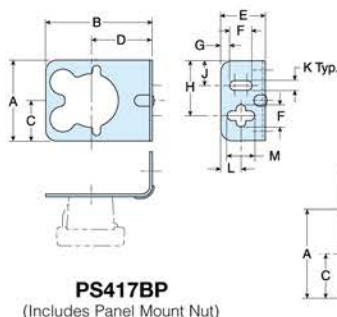

PS417BP

(Includes Panel Mount Nut)

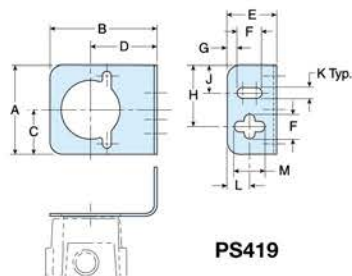

PS419

PS417BP - 10F, 14F, 14R, 14E

A	B	C	D	E	F	G	H	J	K	L	M
46	60	23	34	25	13	5	31	14	6	11	16

PS419 - 04L

A	B	C	D	E	F	G	H	J	K	L	M
46	55	23	34	25	13	5	31	14	6	11	16

Lubricators

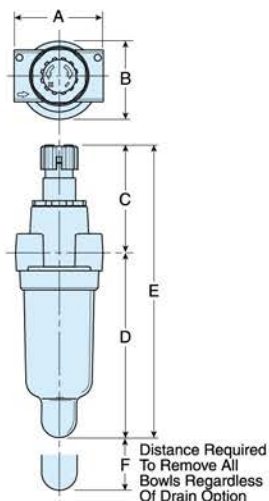

Distance Required To Remove All Bowls Regardless Of Drain Option

A	B	C	D	D'	E	E'	F
44	40	55	92	96	147	151	41

Service kits

Description	Order Code
5 micron particulate element	PS403P
0.01 micron coalescing element	PS446P
Poly bowl with manual drain	PS404P
Poly bowl with pulse drain	PS408BP
Lubricator bowl	PS421P
Regulator	
Relieving type	PS422P
Non-relieving type	PS428P